

HOME® SECURE HD Camera

User Manual



HomeSecure Smart IP HD

Introduction

1	Introduction	3
1.1	Functions	3
2	Get Started	4
2.1	Package contents	4
2.2	Camera Overview	5
3	Installation	6
3.2	Install Camera In App	6
3.3	Access Camera In App	9

Introduction

1.1 Functions

Below is a list of the main functions and specifications of the HomeSecure Smart HD Camera

- **HD 720P resolution** – 1280 x 720 pixels.
- **H.264 Video Compression**
- **Wide Angle** – Diagonal angle 110°
- **Wireless** – Connects to your Wi-Fi network
- **Memory Card Slot** – Up to 32GB micro SD card
- **Remote control via App** – Access the camera via App (iPhone and Android)
- **Live video and sound communication** – Speak through the microphone

Get Started

2.1 Package Content



WiFi Camera×1

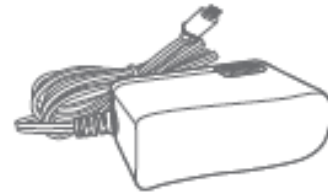

AC Adapter×1

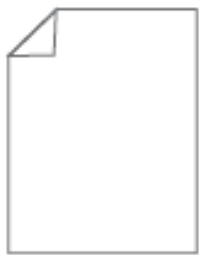

Quick guide×1



Reset Pin×1

2.2 Camera Overview

Overview

- Front View

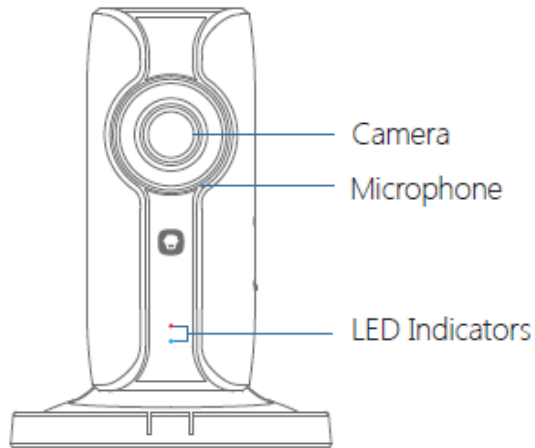

Red indicator	Blinking	Enter WiFi pairing state
Blue indicator	Blinking	Searching network
	On	Network connected

- Side View

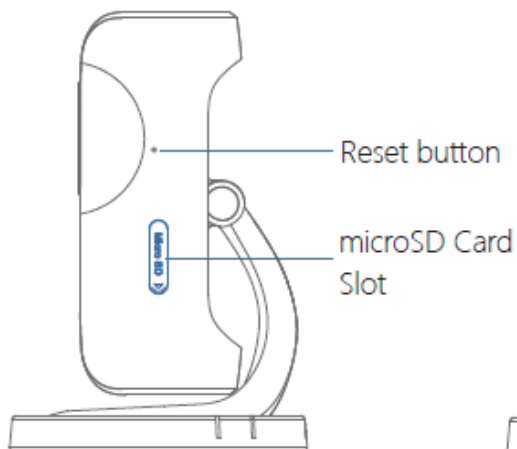

- Back View

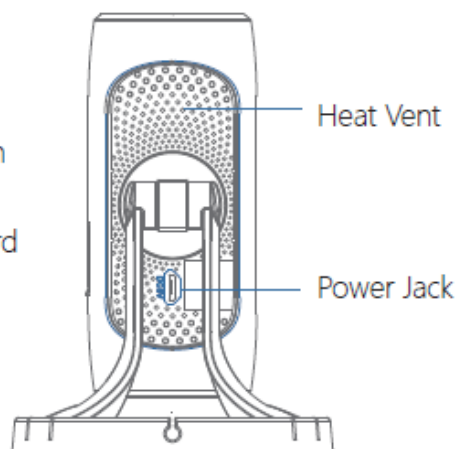

Installation

If you already have a Smart alarm system, you can install the Camera within the same App according to section 3.1.

If you do not have a HomeSecure App, you can install the camera using another App, according to section 4.1.

3.1 Install Via Smart HomeApp

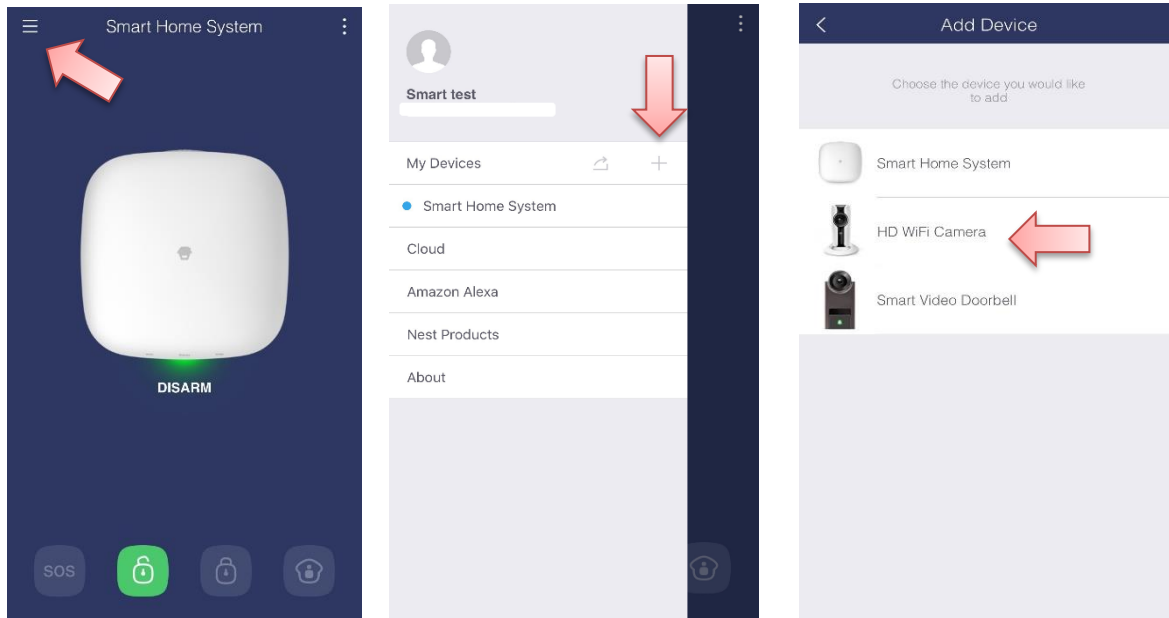

1. Press the lines to access the menu

2. Press the + symbol to add a new device

3. Select "HD WiFi Camera" from the list



4. Connect the power adapter to the camera and press next.



5. Press and hold the reset button until you hear a beep and the red light starts to flash.

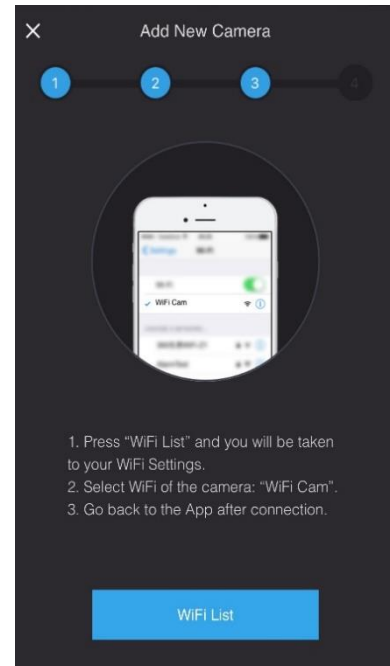

6. Press "WiFi List" and you will be redirected to your devices Wi-Fi lists.

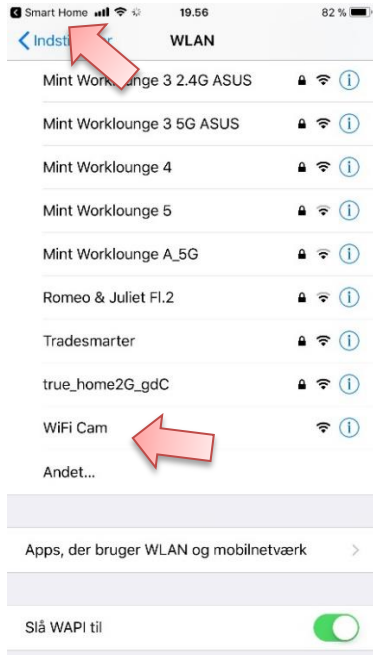

7. Search for "WiFi Cam" and connect to the network "WiFi Cam".

Return to the App when you have connected to the WiFi Cam network.

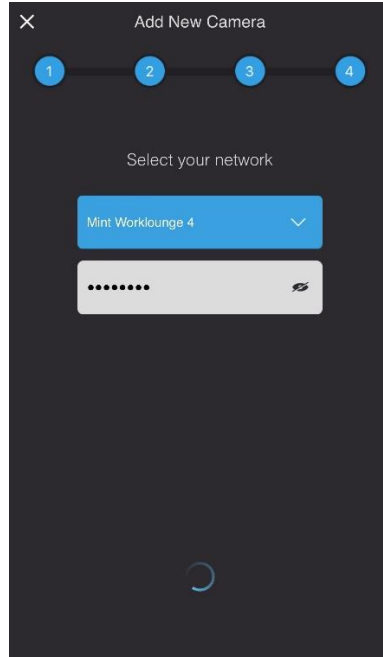

8. Type in your Wi-Fi network password to connect the device to your Wi-Fi network.

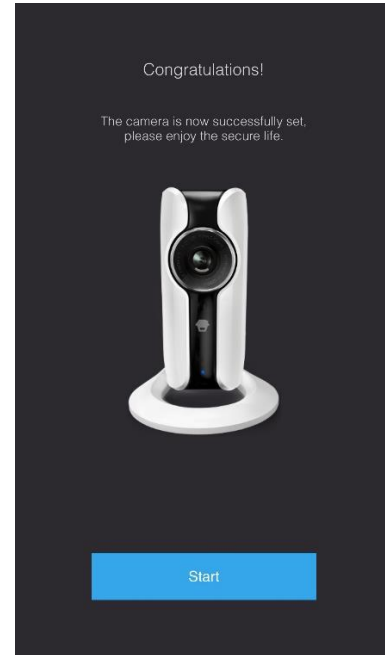

7. The camera is now successfully installed.

3.2 Access Camera In App



1. On the App front page you can swipe to change to Camera view.

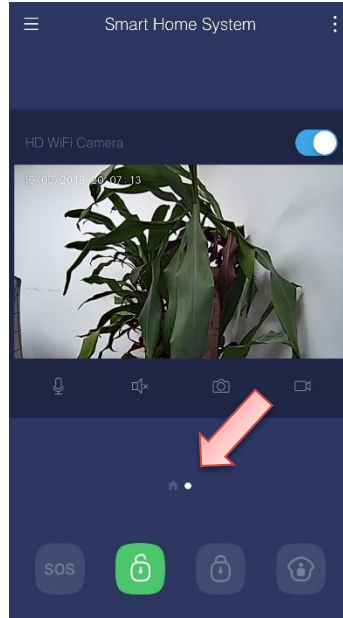

2. In the camera view you can see the live stream and access the camera settings.

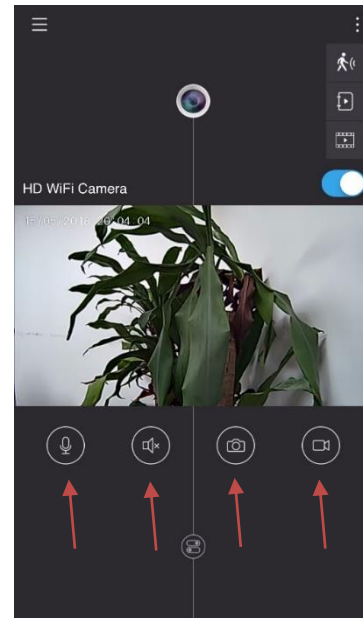

3. There are 4 main functions within the App:

1. Microphone
2. Sound/Mute
3. Snapshot
4. Video recording

4.1 Setup Camera Without Smart Home App

If you do not have a HomeSecure Smart Alarm system, you can use the camera via an App called: **IP116 Plus Camera**



Please follow the installation instructions in the App after downloading the App